



AP-815E

EMERGENCY PANEL

Operation manual

www.t-koko.com

Specifications are subject to be changed without notice.



Specifications

MODEL	AP-815E
MIC IN	<5mV , 600 ohms(Ω),IMBALANCE
LINE IN	<400mV , 10k ohms(Ω),IMBALANCE
LINE OUT	>200mV (SIREN OR RECORD)
FREQUENCY RESPONSE	100 Hz ~ 3.4k Hz (± 3 dB)
THD	<0.01% at 1kHz
ADC/DAC	SAMPLE FREQUENCY:8k Hz 5 Bit
RECORD TIME	1 MINUTE(CAN BE EXTEND TO 2 MINUTES AND 100000 TIMES RE-RECORD)
SAVABLE RECORDS	3 ~ 5 RECORDS, DEPENDS ON THE RECORD TIME FOR EACH
ALARM ACTIVATE IN	1
ALARM ACTIVATE ELECTRIC LEVEL	(0V)SHORT CIRCUIT SIGNAL
FUNCTION CONTROL	1 POWER SWITCH,6 MANUAL CONTROL BUTTONS(SIREN,PLAY,REC, FIRE,START,STOP) ,1 OUTPUT VOL CONTROL,1 REC VOL CONTROL
INDICATOR	'POWER' , 'SIREN' , 'PLAY' , 'REC' , 'FIRE' , 'START' , 'STOP'
PROTECTION	AC FUSE×0.5A×1
POWER CABLE	TWIN(3×0.5 mm ²)×1.5M (STANDARD)
POWER (AC)	AC 115/230V ± 10% 50-60Hz (CHANGE THE POWER INTO 115V OR 230V BY115/230V SWITCH BEFOR USING)
POWER (DC)	DC 24V (CHANGE THE POWER INTO RIGHT POLARITY BY INTERNAL PARTS OF MACHINE BEFORE USING)
AC POWER CONSUMPTION	230V (5~10W) 115V (5-10W)
DC POWER CONSUMPTION	24V (3-10W)
MACHINE SIZE	89(H)×483(W)×366(D) mm
CARTON SIZE	185(H)×520(W)×435(D) mm
G WEIGHT	7.78kg
N WEIGHT	6.08kg

AP-815E Emergency Panel

Emergency Panel AP-815E is used in a public address system to produce an alarm sound either by a short-circuit signal to trigger auto-alarm or by a manual pushbutton. It can output a built-in siren signal or a user-recorded voice alarm or siren. With the built-in 60-second digital recording IC, users may record their own voice alarm or siren. This unit is designed to work with the AP-810P Paging Selector, AP-811P Pre-Amplifier, and AP-813D Speaker Selector.

Front Panel

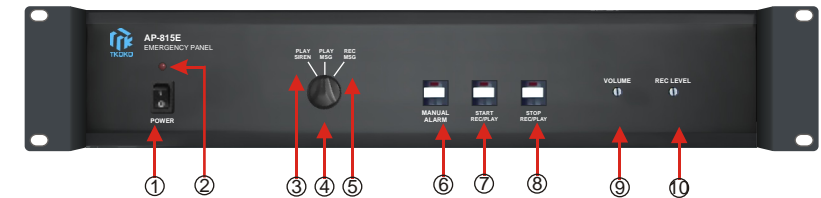

- ① Power Switch
- ② Power Indicator
- ③ SIREN: outputs the Siren the siren sound
- ④ PLAY: outputs the Recording
- ⑤ REC: records the voice message
- ⑥ FIRE: manual alarm button
- ⑦ START: starts recording or playback
- ⑧ STOP: stops recording or playback
- ⑨ Volume Control
- ⑩ Record Level Control

Rear Panel

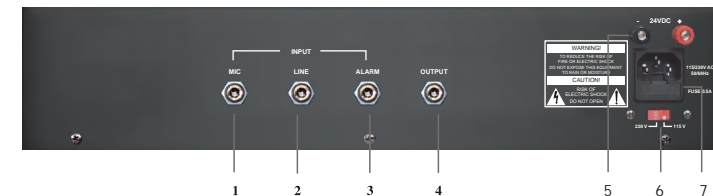

- 1、Mic for record
- 2、Line in for record
- 3、Alarm active input
- 4、Alarm audio output
- 5、DC 24V connection
- 6、AC 115/230V switch
- 7、AC Fuse

Rear Panel Diagram

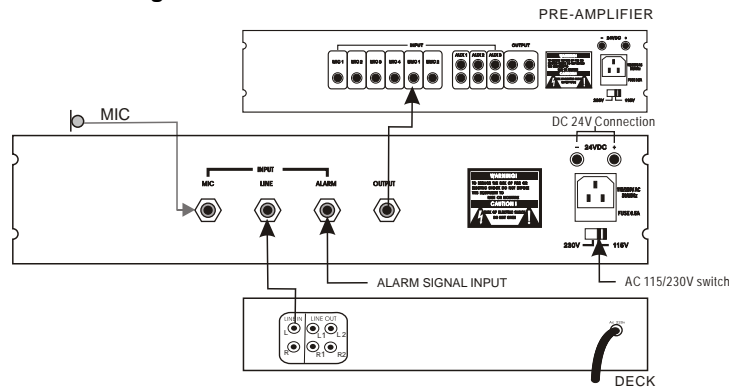

AC115/AC230 conversion notice:

When the switch shows 115 means 115VAC is available

When the switch shows 230 means 230VAC is available

Operation

1. Automatic Mode: Connect the unit's power source plug to the 230V AC supply, regardless of the power switch, and adjust the volume control.

Siren Alarm: Select SIREN with the rotary switch. In this case, so long as the rear panel alarm signal inlet ALARM input short-circuits the warning signal, the outlet OUTPUT at once outputs the siren signal, automatically repeating until the short-circuit warning signal is removed.

User-Recorded Alarm: Select PLAY with the rotary switch. In this case, so long as the rear panel alarm signal inlet ALARM input short-circuits the warning signal, the outlet OUTPUT at once outputs the pre-recorded recording signal, automatically repeating until the short-circuit warning signal is removed.

2. Manual Mode: Connect the unit's power source plug to the 220V AC supply, press down the power switch and adjust the volume control.

Siren Alarm: Select SIREN with the rotary switch. In this case, so long as the FIRE button is pressed down, the outlet OUTPUT at once outputs the siren signal, until the FIRE button is released.

User-Recorded Alarm: Select PLAY with the rotary switch. In this case, so long as the FIRE button is pressed down, the outlet OUTPUT at once outputs the pre-recorded recording signal. Press the START button to pause; press the STOP button to stop playing the recording. If the STOP button is not pressed, the recording signal will play repeatedly.

3. Recording: Select REC with the rotary switch, set the REC LEVEL control to the middle position and turn on the power switch. Press down the START button; use the MIC or LINE inputs to record the signal to the built-in digital IC. Press down the STOP button to stop recording. The maximum recording length is 60 seconds. When the recording time reaches 60 seconds, recording will automatically stop. If it is necessary to partition the recording, press the START button in the partition place to suspend recording, press the START button again to continue recording. After recording, if the recording is not satisfactory, adjust the sound recording level then try again.

Please Note:

1. Inside there is a high-voltage power supply. Please do not open the unit's cover in order to prevent an electric shock.
2. If the unit malfunctions, please refer servicing to qualified service personnel, otherwise mishaps that occur will not be the responsibility of this company.